

ARTISAN®

Model

114 W

**Single Thread Chainstitch
Embroidery Machine**



Operators Manual
and
Spare Parts Booklet

Part NO.	Name of part	QTY
GY10-1.2-27-5	Nipple (ϕ 1.5)	1
GY10-1.2-56A	Presser Foot	1
GY10-1.3-62	Hook Again And Again	2
GY10-1.3-69	Head Cushion	2
GY10-1.3-70	Triangle Pad	2
GY10-1.3-33	Threader Spring	1
GY10-1.3-41	Triangle (M-37)	1
GY10-1.3-42	Motor Wheel	1
GY10-1.3-45	Tweezers	1
GY10-1.3-46	Spanner	1
GY10-1.3-47	Screw Driver (Large)	1
GY10-1.3-48	Screw Driver (Middle)	1
GY10-1.3-49	Screw Driver (Small)	1
GY10-1.3-52	Embroidery Scissors	1
GY10-1.3-53	Pliers	1
GY10-1.3-58	Inside-Hexagonal Wrench M3	1
GY10-1.3-59	Oiler	1
GY10-1.3-60	Brush	1
GY10-1.3-67	Screw	4
Y2-2-16	Presser Foot Shoe (Rubber)	4
PH×1 WS	Needle	1

Description

The embroidery machine makes the single thread chain stitch and can be quickly adjusted to make the drop or moss stitch without unthreading the machine. It is designed for ornamenting or embroidering curtains, upholstery, dresses, scarfs, gloves, tale covers, lace, etc. The machine also can make linen and towels for hotels, etc., by stitching a name into the material .

The thread may be of cotton, wool, worsted, silk ,metal and other threads of similar adaptability. A lager variety of fabrics can be embroidered ranging from fine chiffon to china silk and cloth.

The usual method of producing embroidered designs is to follow a pattern that has been perforated. Stamped or traced on the fabric, but with practice the operator can produce embroidery designs without pro-marking the fabric.

Speed

When first operating this machine, the best results can be obtained by running the machine at approximately 800 stitches per minute. The speed can be increased as the operator becomes more proficient and the nature of the work permits.

To oil the machine

To insure easy running and prevent unnecessary wear of the parts which are in movable contact ,the machine requires oiling.

Oil should be applied to the places designated by unlettered arrows in figs.1.2 , 9 and 10.

Fig .2 shows the arm cover removed for the purpose of oiling. This arm cover can be removed after taking out thumb screw **W**, fig .8.

If the machine is used continuously, oil should be applied at least once each day .

Needles, nipples and thread

Needles for Artisan model 114W are system 137-1 and are available in sizes from 1 to 12. These needles have hooks similar in appearance to those of hand crochet needles. The needle must be selected according to the thickness and the

style of the thread to be used. The thread must not only fill the opening of the hook in the needle but must slide freely therein. To correspond with the needle used in the machine a suitable nipple must be selected, as the needle in forming the stitch has to operate through the nipple. The needle must fit in the nipple and slide freely without side play. Nipples are available in size numbers similar to those of the needles, and for general work the number of the nipple should be the same as that of the needle.

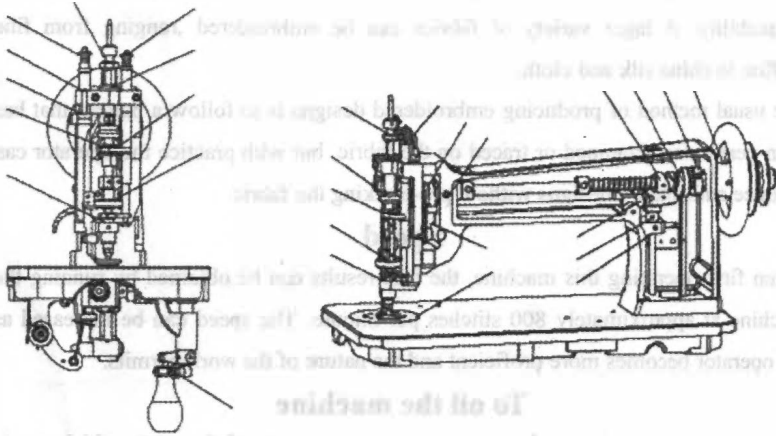

Fig. 1. End view of machine showing oiling points

Fig. 2. Oiling points at the front of the machine

To remove, replace and set needle and nipple

When it is necessary to change the needle and nipple on the machine, first select another needle and corresponding nipple. Then lower the presser bar, loosen wing screw B, fig. 3 and remove needle bolder A and needle from top of machine. Unscrew nipple N. Using the small wrench provided.

Select the correct needle hole in needle plate D.

NOTE: The needle hole should be slightly larger than the needle, so that the needle, when laid around the needle, will have sufficient space to pass without touching the

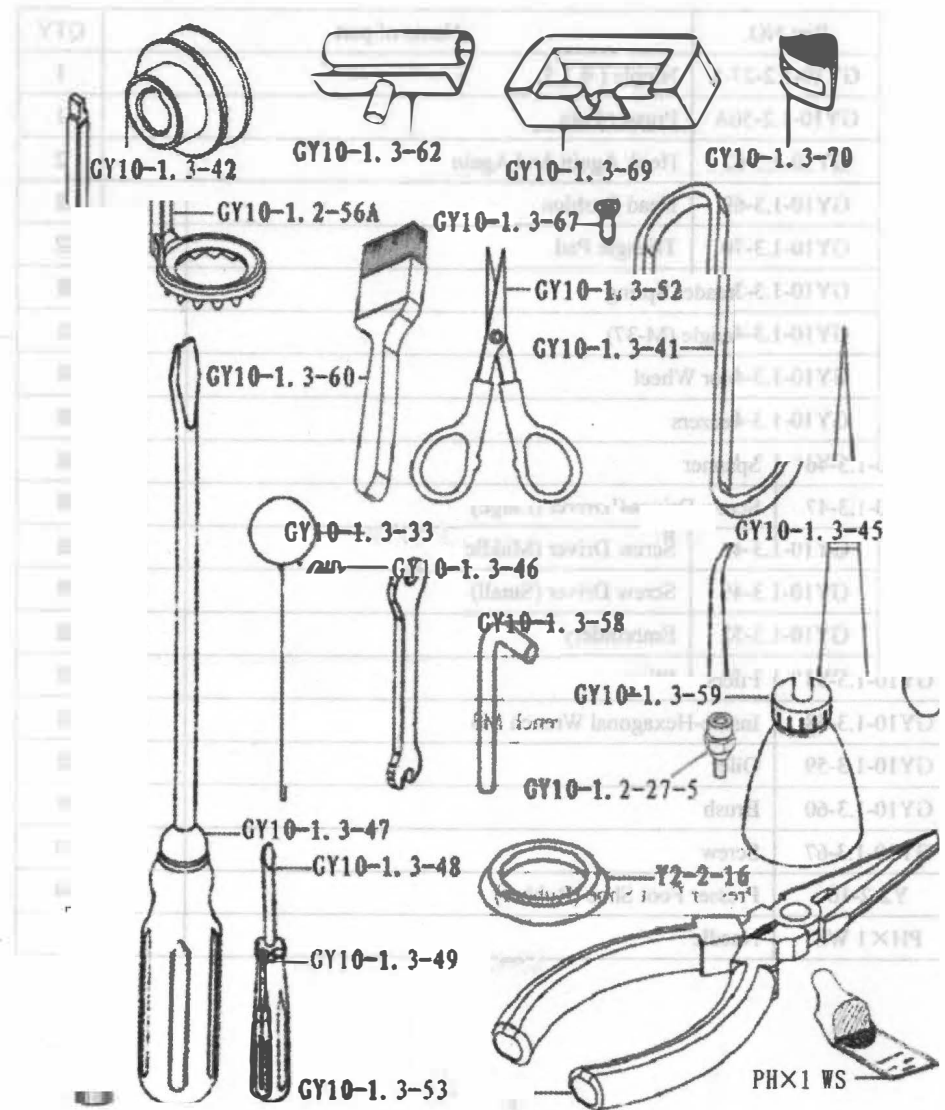

Part NO.	Name of part	QTY
GY10-1.1-1	Arm Head Cover	1
GY10-1.1-5	Arm Side Cover	1
GY10-1.1-6	Machine Sign	1
GY10-1.1-64	Arm Side Cover Set Screw	1
GY10-1.1-66	Machine Frame Hole Screw	1
GY10-1.1-69	Position Pin	2
GY10-1.2-1	Arm Head Bracket	1
GY10-1.2-15	Needle Space Adjusting Screw	1
GY10-1.2-16	Needle Space Adjusting Screw Set Nut	1
GY10-1.2-37	Arm Head Bracket Long Screw	1
GY10-1.2-38	Arm Head Bracket Short Screw	1
GY10-1.2-45	Arm Head Cover Screw	1
GY10-1.2-51	Arm Head Bracket Lower Screw	1
GY10-1.2-60	Position Pin A3 × 16	1
6A2-09	Screw	1
6A4-16	Screw M4 × 10	1

sides of the needle hole .

Loosen thumb screw **L** and turn plate **D** until correct needle hole is in line with needle, then tighten thumb screw **L**. Next, screw selected nipple into the lower end of nipple carrier **O** and tighten securely with the small wrench. Screw selected needle into either end of needle holder **A** and tighten with pliers provided. Replace needle holder **A** down into sleeve and adjust its height so that the fabric to be embroidered can just pass the point of the needle .

Be sure handle **K** is as far to the front as possible and the hook of needle faces the front. Then tighten wing screw **B**, which also should face the front .

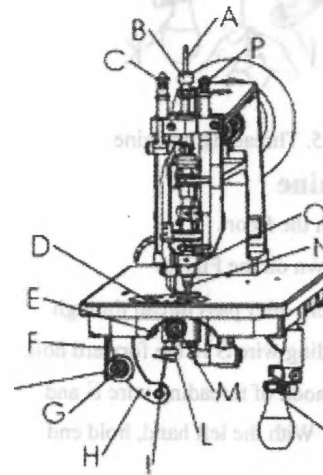

- A. Needle holder
- B. Wing screw for needle holder
- C. Thump screw for regulating pressure on presser foot
- D. Needle plate
- E. Tension regulating lever
- F. Tension regulating plate
- G. Tension complete
- H. Tension bracket
- I. Tread controller spring
- K. Handle for directing feed and operating stop motion
- L. Thumb screw for holding needle plate
- M. End for looper shaft
- N. Nipple
- O. Nipple carrier
- P. Thumb screw for regulating pressure on nipple

Fig. 3. Adjustment on the machine

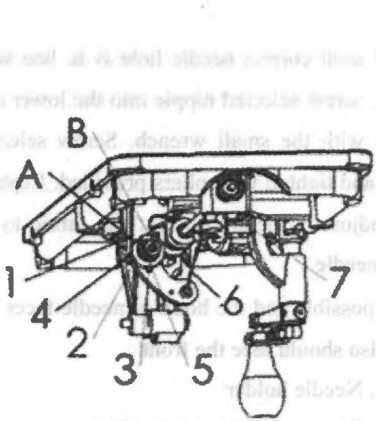

Fig. 4. Threading machine

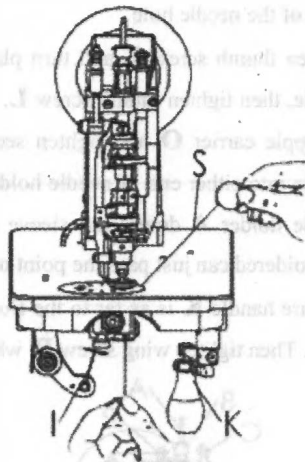

Fig. 5. Threading machine

To thread the machine

Place the cone of thread on the thread stand mounted on the lower stand legs.

Thread the machine according to the drawing shown in the Fig. 4.

Turn handle **K**. Fig. 5 to the front or slightly to the left, then pass the thread through thread tension #3, raise the presser foot and insert the threading wire **S** in the forward hole #4 needle plate. With your left hand, catch the thread on hook of the threading wire **S** and pull the wire up through hole in the needle plate. With the left hand, hold the end of thread with a slight tension.

With the right hand, turn handle **K** straight to the left and, turn the machine over by hand, quickly pull down, then push up on handle **K** so that the needle will pick up the thread for one stitch.

Keep handle **K** in same position and, with the threading wire, draw thread directly toward you, laying end of thread loosely on needle plate after it comes up through needle hole. The machine is then ready for operation.

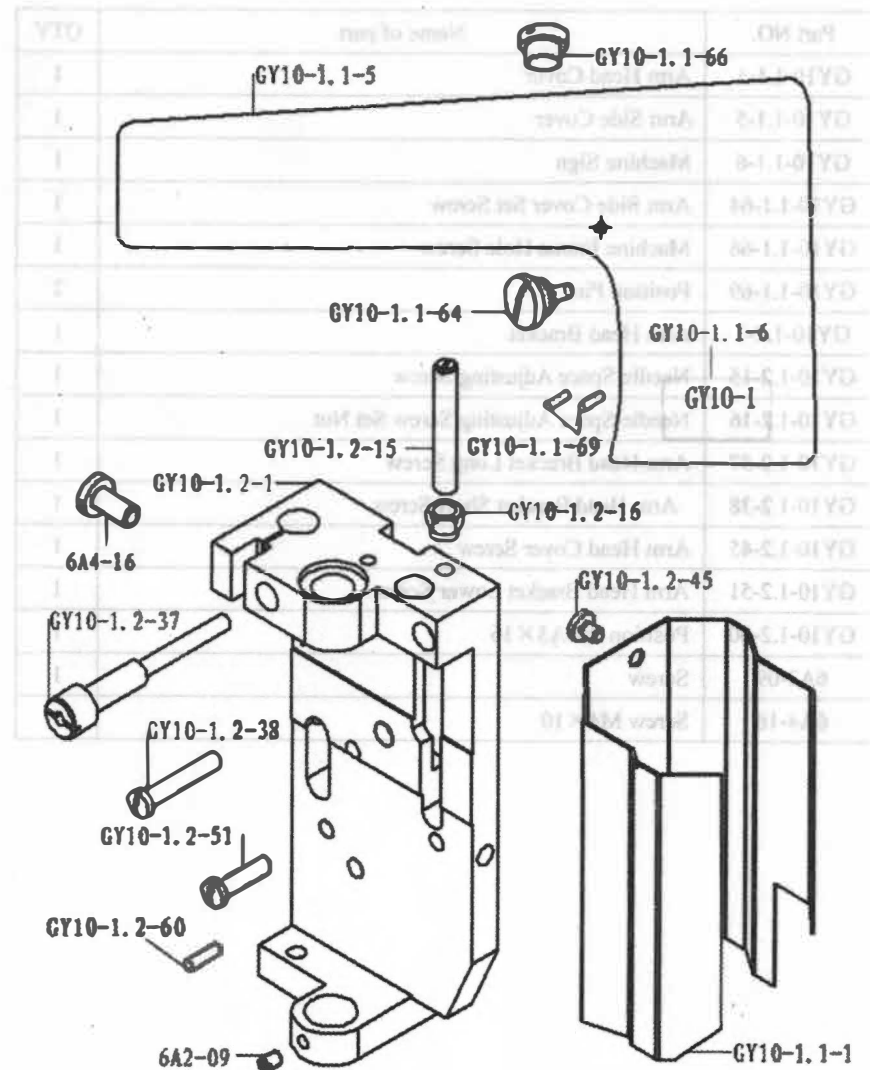

Part NO.	Name of part	QTY
GY10-1.2-2	Presser Foot Lifter	1
GY10-1.2-3	Presser Foot Lifter Screw	1
GY10-1.2-4	Presser Foot Side Bell Crank	1
GY10-1.2-5	Nipple Carrier Bell Crank	1
GY10-1.2-6	Nipple Carrier Bell Crank Hinge Stud	2
GY10-1.2-7	Feed Bell Crank Roller	1
GY10-1.2-8	Feed Bell Crank Roller Screw	1
GY10-1.2-9	Feed Bell Crank	1
GY10-1.2-10	Feed Bell Crank Spring	1
GY10-1.2-11	Feed Bell Crank Hinge Stud	1
GY10-1.2-12	Needle Operating Side	1
1037	Screw	3

Learning to operate the machine

NOTE: The new Artisan model 114 W runs in a clockwise direction of rotation.

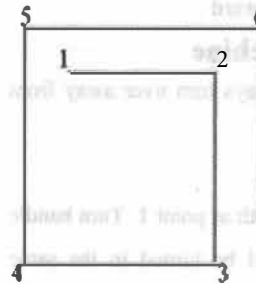

Mark a design (see Fig. 6) on a 12 inch square piece of cloth. Place the cloth under presser foot so that needle will enter cloth at point 1

Turn the handle K. Fig. 3 to the right and the hook of the needle will be turned in the same direction. Lower the presser foot, turn the handwheel in a clockwise rotation.

To operate the machine

The operator should practice embroidering designs similar to those illustrated below.



Fig.7. Designs for beginners

These designs can be sketched on material such as muslin. By following these patterns, the operator can soon become proficient enough to attempt more intricate designs or patterns.

To regulate the pressure on the presser foot

The pressure on the presser foot is regulated by the thumb screw **C**, Fig. 3 . To increase the pressure, turn the thumb screw over to the right or downward.

To decrease the pressure, turn the screw over to the left or upward .

Learning to operate the machine

NOTE: When in operation the machine pulley must always turn over away from operator. The machines runs in a clockwise direction of rotation.

Mark a design (see Fig .6) on a 12 inch square piece cloth .

Place cloth under the presser foot so that the needle enters cloth at point 1. Turn handle **K**, Fig. 3 to the right and the hook of the needle will be turned in the same direction. With the servo motor power turned on, lower the sewing machines presser foot. Pressing the treadle located above the floor with your foot will begin the rotation of the motor and operate the sewing machine. Turn the handle to the right , cloth will be fed to point 2, then turn handle to the front and cloth will be fed to point 3, turn handle to the left and cloth will be feed to point 4, etc .

To regulate the pressure on the presser foot

The pressure on the presser foot is regulated by the thumb screw **C** , Fig. 3 . To increase the pressure , turn thumb screw over to the left or downward. To decrease the pressure turn the thumb screw over to the left or upward .

Tensions

If stitches are too tight, raise the needle holder approximately 1/16 inch .

Various effects can be produced by changing the height of the needle holder as well as by adjusting the stitch length.

The tension on the thread is regulated by the thumb nut **B**, Fig. 4 at the left of the tension discs. To increase the tension turn this nut clockwise. To decrease the tension turn this thumb nut counter clockwise. This tension should be only tight enough to prevent the skipping stitches.

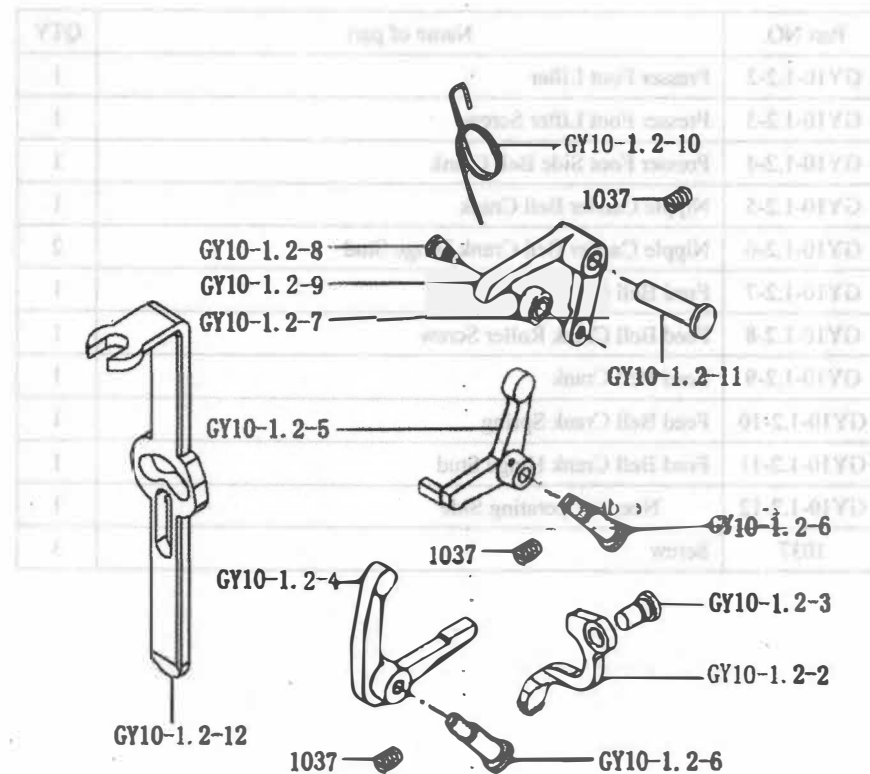

Part NO.	Name of part	QTY
GY10-1.2-2P	Press Foot Bracket Assembly	1
GY10-1.2-22	Nipple Carrier Lifting Screw Stud	1
GY10-1.2-28	Nipple Carrier Guide Screw	1
GY10-1.2-29	Nipple Carrier Guide	1
GY10-1.2-30	Nipple Carrier	1
GY10-1.2-34	Feed Side Bar	1
GY10-1.2-35	Nipple Carrier Extension	1
GY10-1.2-36	Nipple Carrier Spring	1
GY10-1.2-39	Nipple Pressure Adjusting Screw	1
GY10-1.2-40	Nipple Pressure Adjusting nut	1
GY10-1.2-41	Press Foot Pressure Adjusting Screw	1
GY10-1.2-42	Press Foot Pressure Adjusting Nut	1
GY10-1.2-43	Presser Foot Side Bar Spring	1
GY10-1.2-44	Presser Foot Plunger	1
GY10-1.2-45	Press Foot Lever Swivel Screw	1
GY10-1.2-46	Press Foot Lever Swivel	1
GY10-1.2-47	Press Foot Lever Swivel Hinge Screw	2
GY10-1.2-48	Presser Foot Side Bar Guide	1
GY10-1.2-49	Presser Foot Lifting Bar Spring Stop	1
GY10-1.2-52	Presser Foot Side Bar	1
GY10-1.2-55	Press Foot Clamp	1
Y2-2-16	Presser Foot Shoe (Rubber)	1
GY10-1.2-56	Presser Foot	1
GY10-1.2-58	Nipple Guide	1
6A5-04	Screw	1
1035-1	Screw	1
1037	Screw	1

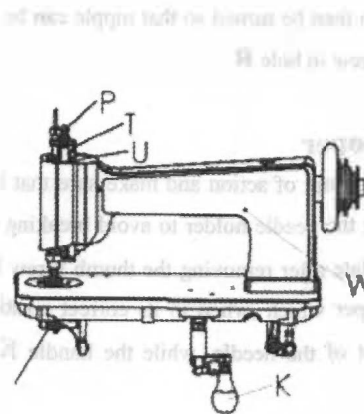

Fig.8. Adjustments on the machine

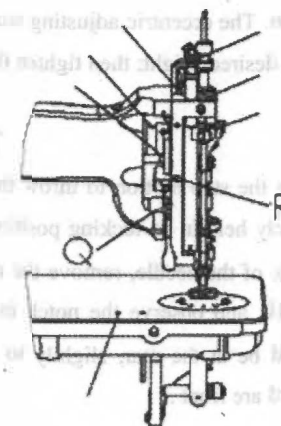

Fig.9. Oiling points and adjustments at the back of the machine

To adjust the length of stitch

The length of stitch is adjusted by screw T, Fig. 8. To lengthen the stitch, loosen locking lever U and turn screw T over to the left or upward, then tighten locking lever U.

To shorten the stitch, loosen locking lever U and turn the screw T over to the right or downward, then tighten locking lever U.

To regulate the pressure on the nipple

The pressure on the nipple is regulated by the thumb screw P, Fig. 8 at the top of the machine. To increase the pressure, turn this thumb screw over to the right or downward. To decrease the pressure, turn this thumb screw over to the left or upward.

NOTE: Too much pressure on the nipple may cause the thread to break.

When sewing fine net, it is sometimes necessary to prevent the nipple from touching the needle plate.

To raise the nipple, insert a screw driver in hole R, Fig. 9 and loosen the set screw

The eccentric adjusting stud **Q** can then be turned so that nipple can be set at the desired height; then tighten the set screw in hole **R**.

The looper

Allow the stop motion to throw the machine out of action and make sure that it is securely held in its locking position. Raise the needle holder to avoid breaking the posing of the needle, remove the needle plate after removing the thumb screw **L**, Fig. 10, and observe the notch in the looper which, when in its correct position, should be at the rear, slightly to the right of the needle, while the handle **K** is toward the front.

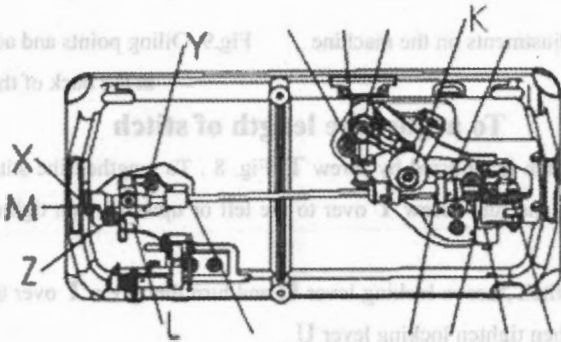
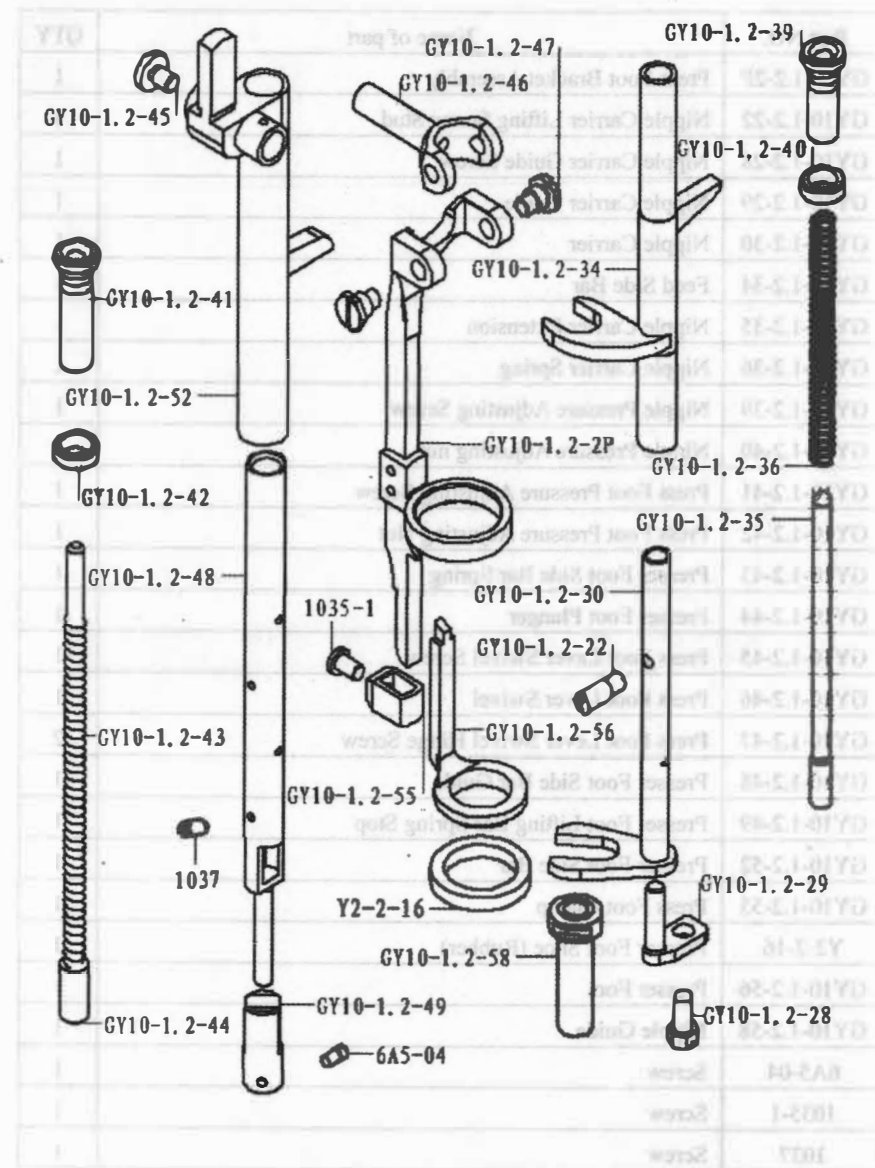

Fig. 10. Oiling points adjustments in back of machine

To set the looper

Turn the machine on its back and turn handle **K**, Fig. 10 and wing screw **B**, Fig. 3 to the front. Loosen set screw **X**, Fig. 10 of the operating worm gear **Y**, and turn the gear slightly, until the notch in the looper is in its correct position as instructed above. After having set the worm gear flush with the end of the looper shaft **M**, tighten the set screw **X**.



Part NO.	Name of part	QTY
GY10-1.2-1P	Arm Head Sleeve Assembly	1
GY10-1.2-13	Needle Holder Clamping Sleeve	1
GY10-1.2-14	Needle Bar	1
GY10-1.2-17	Arm Head Sleeve Cap	1
GY10-1.2-20	Arm Head Sleeve Gear	1
GY10-1.2-21	Feed Side Block	1
GY10-1.2-23	Feed Recovering Spring(Left)	1
GY10-1.2-24	Feed Recovering Spring(Right)	1
GY10-1.2-25	Feed Recovering Spring Screw	2
GY10-1.2-26	Nipple Carrier Sleeve Bushing	1
GY10-1.2-27	Nipple	1
GY10-1.2-31	Feed Lever Bracket Guide	1
GY10-1.2-32	Feed Lever Bracket Guide Cap	1
GY10-1.2-33	Feed Lever Bracket	1
GY10-1.2-50	Feed Lever	1
GY10-1.2-59	Pin	1
GY10-1.2-61	Pin A2×12	1
GY10-1.3-1	Feed Rotating Shaft Gear	1
GY10-1.3-2	Feed Rotating Shaft	1
Y2-1-14	Screw	1
PH×1 WS	Needle	1
1035	Screw	1
6A2-09	Screw	3
6A2-09-3	Screw	1
6A5-11	Screw	2
1035	Screw	1

Pile or moss stitch

The raised pile or moss stitch is produced by adjusting the machine so that it will drop the stitches in loose loops on the material. To accomplish this, turn handle **K** to the front, loosen the wing screw **B**, Fig. 3 and turn the needle holder so that the hook of the needle will point directly to the back of the machine, then tighten the wing screw. Reach under the bed of machine with the left hand, grasp the knurled end **Z**, Fig. 10 of the operating worm gear, draw the worm gear to the left and while holding it, turn handle **K** around to the right directly to the back, then release the knurled of the gear.

The looper will then be set in the opposite direction to that which is required for the chain stitch, or with the notch of the looper at the front of the needle while handle **K** is at the front .

By operating the machine and turning handle **K** rapidly , so as to make very small circles of dropped stitch loops laid one on the other, raised pile work is produced. The higher the needle is set the longer the loop will be. The size of the thread and thickness of the material used will have to be considered when adjusting the machine for pile stitching .

	Trouble	Cause	Corrective Measure
1	Stitch skipping	The timing between the needle and the looper is off .	Correct the timing between the needle and the looper .
2	Breakage therad	Thread and needle are not suitable or thread tension is too high .	Adjust thread tension or replace suitable needle and thread .
3	Breakage needle	Needle position is set too low or thread knots under the needle plate because of feeding retardation.	Adjust the high of the needle. Check the feeding mechanism. Practice and learn to operate the mach.
4	Feeding cloth retardation	Presser foot doesn't hold the fabric or the pressure is too low. The feeding system requires attention.	Adjust the presser foot height and its downward pressure. Check the feed system sychronization.

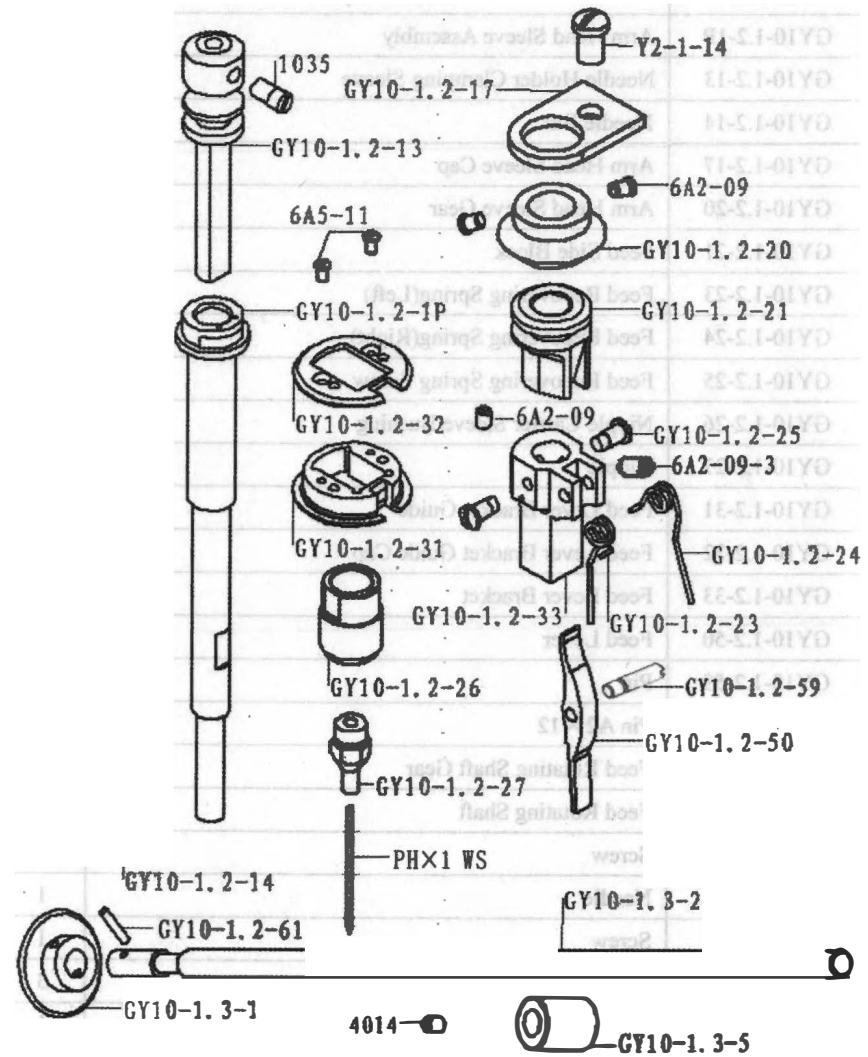

Part NO.	Name of part	QTY
GY10-1.1-34	Looper Operating Bell Crank Bracket Set Screw	2
GY10-1.1-38	Tension Bracket	1
GY10-1.1-39	Tension Regulating Lever Screw	1
GY10-1.1-40	Washer	1
GY10-1.1-41	Tension Stud	1
GY10-1.1-42	Tension Screw	1
GY10-1.1-43	Tension Regulating Spring	1
GY10-1.1-44	Tension Regulating Spring Screw	1
GY10-1.1-45	Tension Regulating Plate Screw	1
GY10-1.1-46	Tension Disc	2
GY10-1.1-47	Tension Regulating Lever	1
GY10-1.1-52	Thread Controller Spring	1
GY10-1.1-53	Tension Regulating Plate	1
1036-1	Tension Nut	1
1036-3-3	Tension Spring	1
1018	Thread Controller Spring Screw	1
4010	Tension Stud Nut	1

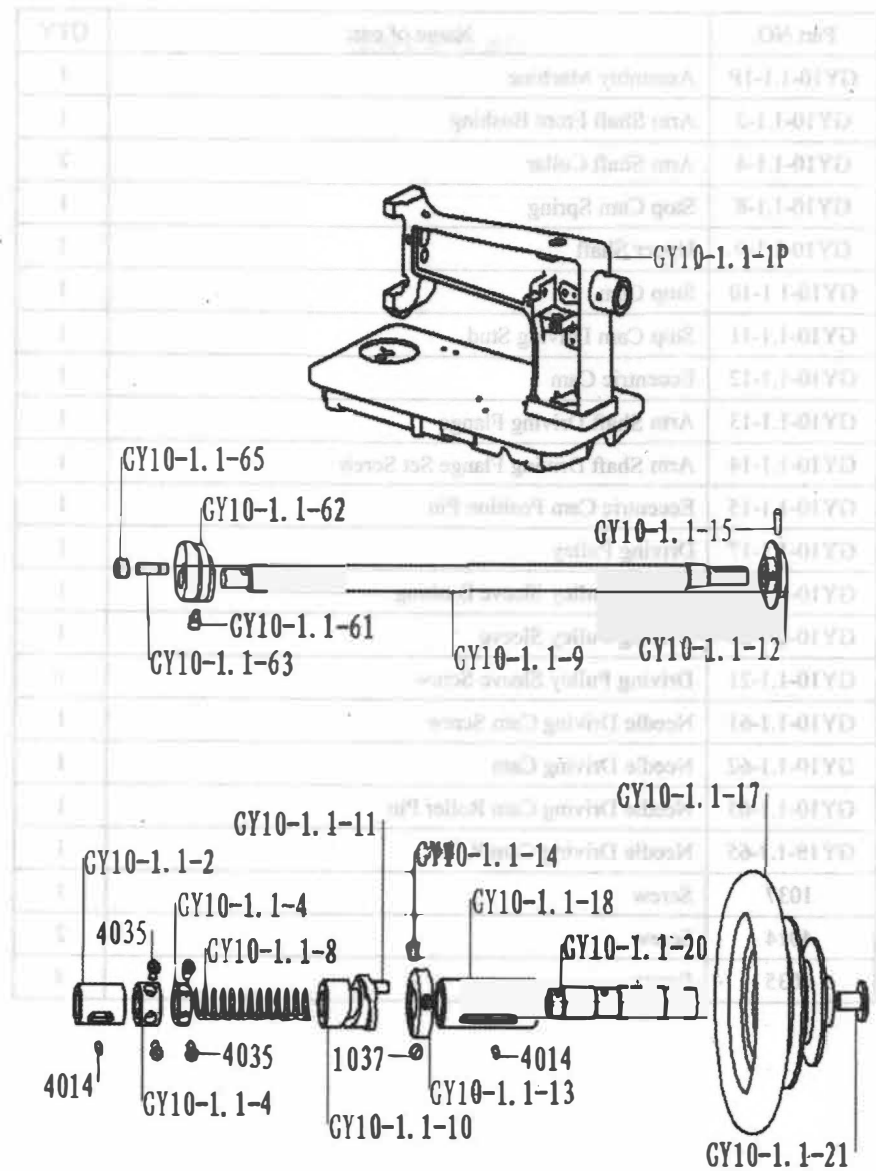

Part NO.	Name of part	QTY
GY10-1.1-1P	Assembly Machine	1
GY10-1.1-2	Arm Shaft Front Bushing	1
GY10-1.1-4	Arm Shaft Collar	2
GY10-1.1-8	Stop Cam Spring	1
GY10-1.1-9	Upper Shaft	1
GY10-1.1-10	Stop Cam	1
GY10-1.1-11	Stop Cam Driving Stud	1
GY10-1.1-12	Eccentric Cam	1
GY10-1.1-13	Arm Shaft Driving Flange	1
GY10-1.1-14	Arm Shaft Driving Flange Set Screw	1
GY10-1.1-15	Eccentric Cam Position Pin	1
GY10-1.1-17	Driving Pulley	1
GY10-1.1-18	Driving Pulley Sleeve Bushing	1
GY10-1.1-20	Driving Pulley Sleeve	1
GY10-1.1-21	Driving Pulley Sleeve Screw	1
GY10-1.1-61	Needle Driving Cam Screw	1
GY10-1.1-62	Needle Driving Cam	1
GY10-1.1-63	Needle Driving Cam Roller Pin	1
GY10-1.1-65	Needle Driving Cam Roller	1
1037	Screw	1
4014	Screw	2
4035	Screw	4

(12)

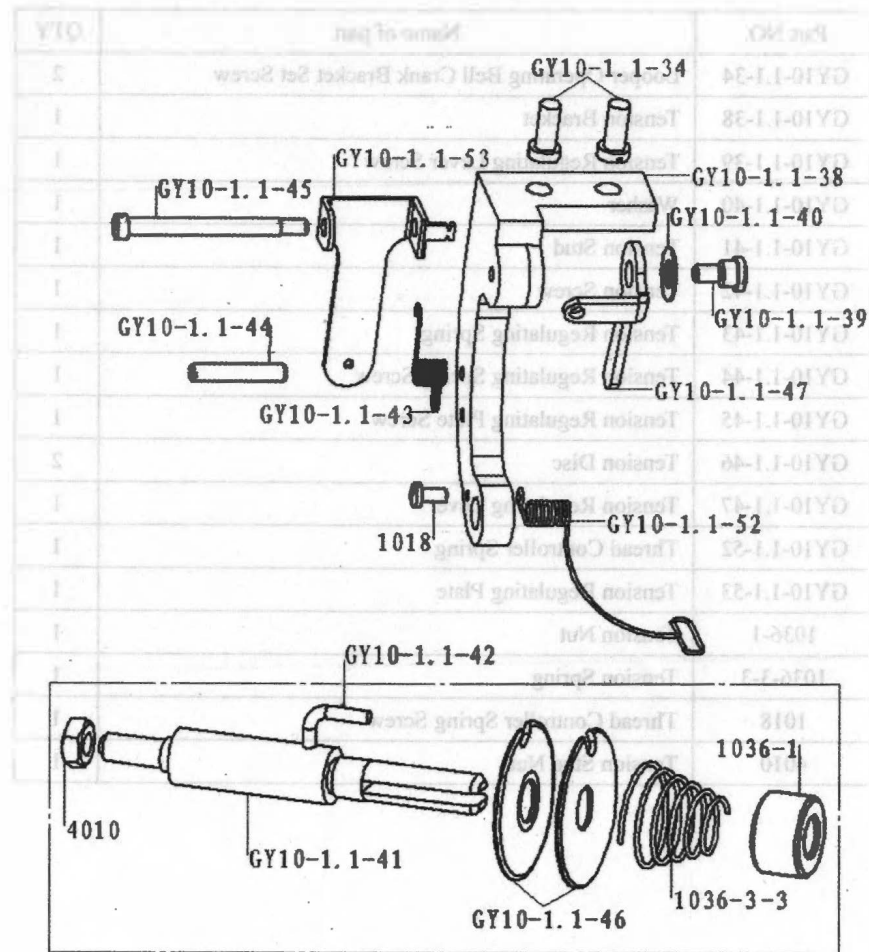

(21)

Part NO.	Name of part	QTY
GY10-1.1-7-1	Stitch Rotating Hand Lever Shaft Sleeve	1
GY10-1.1-16	Pin A4×16	2
GY10-1.1-27-1	Φ6 Washer	1
GY10-1.1-34	Looper Operating Bell Crank Bracket Set Screw	2
GY10-1.1-51	Stitch Rotating Gear Bracket	1
GY10-1.3-3A	Stitch Rotating Gear Bracket Shaft Gear	2
GY10-1.3-14	Stitch Rotating Hand Lever Rod	1
GY10-1.3-15	Stitch Rotating Hand Lever Handle Sleeve	1
GY10-1.3-16	Stitch Rotating Hand Lever Handle	1
GY10-1.3-17	Stitch Rotating Lever	1
GY10-1.3-21	Starting Trip Lever(Intermediate)	1
GY10-1.3-22	Starting Trip Lever Screw	1
GY10-1.3-25	Stitch Rotating Gear Bracket Shaft (Intermediate)	1
GY10-1.3-26	Stitch Rotating Hand Lever Shaft Gear	1
GY10-1.3-27	Stitch Rotating Hand Lever Shaft	1
GY10-1.3-28	Starting Trip Lever	1
GY10-1.3-29	Starting Trip Lever	1
GY10-1.3-30	Starting Trip Lever Screw	1
GY10-1.3-31	Starting Trip Lever Block Screw	1
GY10-1.3-32	Starting Trip Lever Block	1
6A2-09	Screw	6
1035	Screw	2
1037	Screw	1
3028	Screw	1
4014	Screw	1

(20)

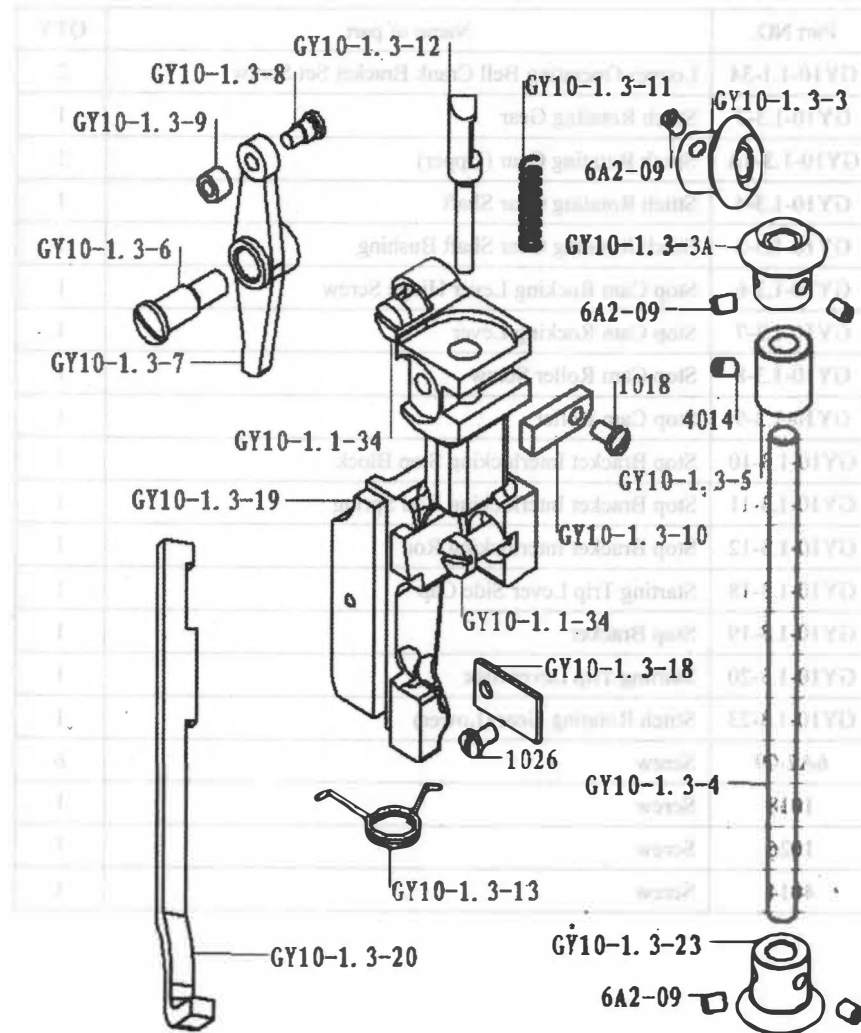

(13)

Part NO.	Name of part	QTY
GY10-1.1-34	Looper Operating Bell Crank Bracket Set Screw	2
GY10-1.3-3	Stitch Rotating Gear	1
GY10-1.3-3A	Stitch Rotating Gear (Upper)	1
GY10-1.3-4	Stitch Rotating Gear Shaft	1
GY10-1.3-5	Stitch Rotating Gear Shaft Bushing	1
GY10-1.3-6	Stop Cam Rocking Lever Hinge Screw	1
GY10-1.3-7	Stop Cam Rocking Lever	1
GY10-1.3-8	Stop Cam Roller Screw	1
GY10-1.3-9	Stop Cam Roller	1
GY10-1.3-10	Stop Bracket Interlocking Stop Block	1
GY10-1.3-11	Stop Bracket Interlocking Rod Spring	1
GY10-1.3-12	Stop Bracket Interlocking Rod	1
GY10-1.3-18	Starting Trip Lever Side Cap	1
GY10-1.3-19	Stop Bracket	1
GY10-1.3-20	Starting Trip Lever Side	1
GY10-1.3-23	Stitch Rotating Gear (Lower)	1
6A2-09	Screw	6
1018	Screw	1
1026	Screw	1
4014	Screw	1

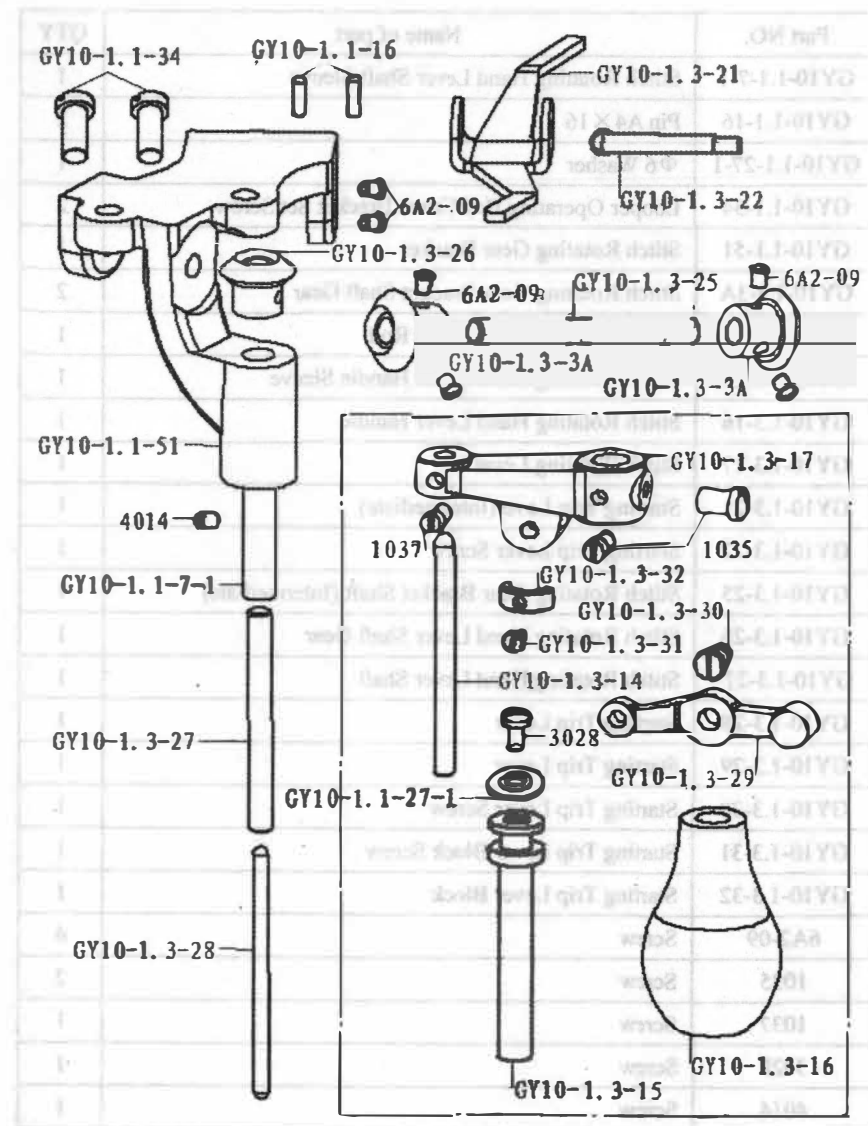

Part NO.	Name of part	QTY
GY10-1.1-4P-1	Looper Operating Connection Joint Assembly	1
GY10-1.1-16	Position Pin A4×16	2
GY10-1.1-19-1	Looper Operating Connection Joint Nut	1
GY10-1.1-23	Looper Operating Connection(Cam End)	1
GY10-1.1-24	Looper Operating Connection Adjusting Nut	1
GY10-1.1-25-1	Looper Operating Connection Adjusting Screw-Bar	1
GY10-1.1-26-1	Nut A	1
GY10-1.1-27-1	Φ6 Washer	1
GY10-1.1-28	Looper Operating Bell Crank	2
GY10-1.1-29	Looper Operating Bell Crank Screw	2
GY10-1.1-30	Looper Operating Bell Crank	1
GY10-1.1-31	Looper Operating Bell Crank Bracket	1
GY10-1.1-32-1	Looper Operating Connection Joint Screw	1
GY10-1.1-33	Looper Operating Bell Crank Screw	1
GY10-1.1-34	Looper Operating Bell Crank Bracket Set Screw	1
GY10-1.1-35	Looper Operating Shaft Guide Block	1
GY10-1.1-36	Looper Operating Shaft Guide	1
GY10-1.1-49	Looper Operating Bell Crank Bracket Set Screw	2
GY10-1.3-24	Looper Operating Shaft Sleeve And Gear	2
6A6-24	Nut	1
6A2-09	Screw	5

(18)

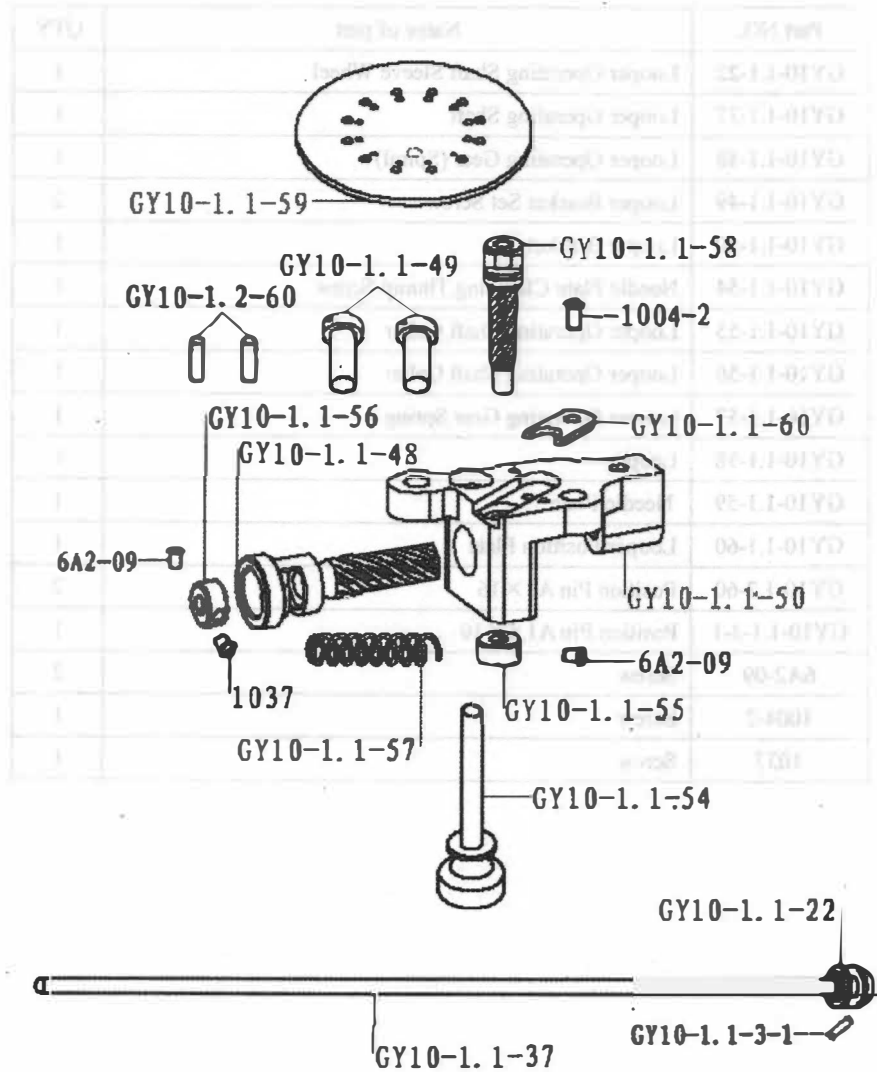

(15)

Part NO.	Name of part	QTY
GY10-1.1-22	Looper Operating Shaft Sleeve Wheel	1
GY10-1.1-37	Looper Operating Shaft	1
GY10-1.1-48	Looper Operating Gear (Spiral)	1
GY10-1.1-49	Looper Bracket Set Screw	2
GY10-1.1-50	Looper Bracket	1
GY10-1.1-54	Needle Plate Clamping Thump Screw	1
GY10-1.1-55	Looper Operating Shaft Collar	1
GY10-1.1-56	Looper Operating Shaft Collar	1
GY10-1.1-57	Looper Operating Gear Spring	1
GY10-1.1-58	Looper	1
GY10-1.1-59	Needle Plate	1
GY10-1.1-60	Looper Position Plate	1
GY10-1.2-60	Position Pin A3 × 16	2
GY10-1.1-3-1	Position Pin A1.5 × 10	1
6A2-09	Screw	2
1004-2	Screw	1
1037	Screw	1

